

### ▲主要应用/Application

广泛用于 APF ,SVG 光伏逆变器 , 风电变频器, 电源 , 变频器 , 电动汽车 电机驱动等设备中起直流支撑和滤波。

### ▲产品特点/Characteristics

电介质：聚丙烯薄膜

结构：金属化膜干式结构

封装：金属铝外壳,阻燃(UL 94V-0)环氧封装

引出：镀锡铜螺母或螺杆引出

高稳定性

低 ESR,ESL

具有自愈性

Dielectric: Polypropylene film

Construction: Extended metalized r film, dry construction

Coating: Aluminum case with resin sealing.

Flame retardant execution(UL 94V-0)

Terminals: Copper nut or screw leads

High stability

Low ESR,ESL

Self healing



### ▲技术性能/Specifications

引用标准/Reference standards	IEC 61071
工作温度范围/Operating temperature range	-40~85°C
容量范围/Capacitance	33~3200μF
额定电压/ Rated Voltage	800 -- 4000 VDC
容量偏差 /Tolerance	±5%, ±10%
极间耐电压 /Test voltage between terminals	1.5Ur(DC) 10s 25±5°C
极壳耐电压/ Test voltage between terminals and case	3000VAC 50Hz 10S, 25±5°C
损耗角正切/Dissipation factor	$tg\delta \leq 1 \times 10^{-3}$ at 25±5°C , 100Hz
绝缘电阻/Insulation resistance	$C \cdot IR \geq 5000S$ , at 100VDC, 25±5°C, 60S
预期寿命/Life expectancy	100000h at Ur and 70°C

### ▲型号编码 Part Numbering System

<b>180</b>	<b>FG</b>	<b>297</b>	<b>K</b>	<b>76120</b>
电压 Voltage	系列 Type	容量 Capacitance	误差 Tolerance	尺寸 Size
180=800vdc	FG	296=29uf	K= ±10%	76*120
211=1100vdc		297=290uf	J= ±5%	
236=3600vdc		298=2900uf		

### ▲外形图/Outline drawing

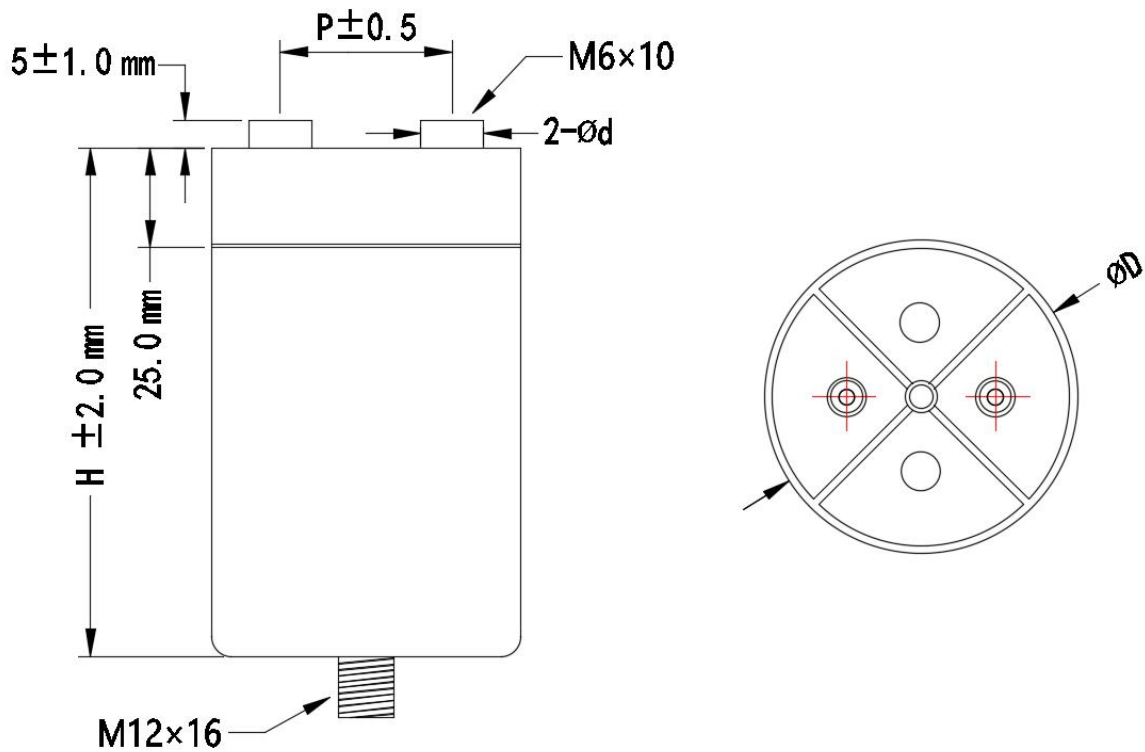

D= 76, 86mm	D= 96mm	D= 116mm	D= 136mm
d= 12.5mm	d= 12.5mm	d= 14mm	d= 14mm
P= 32mm	P= 45mm	P= 50mm	P= 50mm

### ▲Technical Data

Cap (UF)	D mm	H mm	I <sub>peak</sub> (KA)	I <sub>rms</sub> @10Khz @45°C(A)	ESR@1.0K hz(MΩ)	L <sub>s</sub> (nH)	R <sub>th</sub> (k/W)	W <sub>n</sub> (Ws)	Weight (kg)	Part number
Un 800v.DC Us 1050vDC Ur 180vAC										
290	76	120	3.3	63	1.2	≤45	3.9	106	0.65	180FG297K76120
380	86	145	3.3	74	1.5	≤55	2.6	163	1.1	180FG387K86145
400	76	120	1.9	34	3.5	≤60	4.1	115	0.65	180FG407K76120
430	76	120	3.0	40	1.4	≤50	3.2	128	0.65	180FG437K76120
480	86	120	4.7	74	0.8	≤45	3.3	145	0.85	180FG487K86120
520	86	145	4.3	76	1.1	≤45	2.9	180	1.1	180FG527K86145
550	86	145	4.5	56	1.6	≤60	2.6	150	1.1	180FG557K86145
580	86	145	4.6	66	1.2	≤55	2.4	220	1.3	180FG587K86145
630	86	225	3.7	56	1.8	≤60	2.2	229	1.3	180FG637K86225
650	86	225	4.7	78	1.5	≤60	3.0	300	1.7	180FG657K86225
720	116	125	8.6	95	0.8	≤50	2.2	427	1.7	180FG727K116125

### ▲Technical Data

Cap (UF)	D mm	H mm	I <sub>peak</sub> (KA)	I <sub>rms</sub> @10Khz @45°C(A)	ESR@1.0K hz(MΩ)	L <sub>s</sub> (nH)	R <sub>th</sub> (k/W)	W <sub>n</sub> (Ws)	Weight (kg)	Part number
			Un 800v.DC		Us 1050vDC	Ur 180vAC				
750	86	225	4.9	80	1.4	≤60	1.8	305	1.7	180FG757K86225
800	86	225	6.7	82	1.5	≤60	2.1	325	1.7	180FG807K86225
980	116	125	9.7	96	0.9	≤50	1.7	600	1.7	180FG987K116125
1100	116	150	8.2	95	0.7	≤45	2.6	335	2.1	180FG118K116150
1200	116	150	12.9	103	0.8	≤60	1.6	798	2.1	180FG128K116150
1200	116	180	12.9	103	0.85	≤60	3.6	798	2.4	180FG128K116180
1500	116	180	13.2	103	1.0	≤50	3.4	800	2.4	180FG158K116180
1800	116	230	13.3	105	0.8	≤60	2.7	800	4.2	180FG188K116230
3200	136	295	13.5	110	1.0	≤60	3.0	850	4.5	180FG328K136295
			Un 900v.DC		Us 1350vDC	Ur 200vAC				
290	76	125	3.3	60	1.3	≤41	3.6	151	0.74	190FG297K76125
380	76	125	3.4	61	1.7	≤51	2.6	232	0.75	190FG387K76125
400	76	125	1.6	33	3.6	≤60	3.8	159	0.71	190FG407K76125
450	76	145	3.2	61	1.2	≤46	3.1	183	0.84	190FG457K76145
480	86	125	4.4	71	0.8	≤41	3.2	199	0.94	190FG487K86125
520	86	120	4.2	72	1.2	≤46	2.8	244	0.91	190FG527K86120
560	86	175	2.1	40	3.0	≤60	3.4	212	1.0	190FG567K86175
580	86	175	4.5	73	1.4	≤50	2.3	305	1.1	190FG587K86175
630	86	145	3.1	63	2.1	≤50	1.9	217	1.2	190FG637K86145
650	86	145	4.0	53	1.7	≤60	2.8	406	1.3	190FG657K86145
720	86	175	8.7	90	0.8	≤46	2.0	589	1.4	190FG727K86175
780	76	225	4.2	76	1.6	≤60	1.7	426	1.4	190FG787K76225
980	116	125	8.0	92	0.8	≤50	1.6	811	1.7	190FG987K116125
1100	116	150	7.7	88	0.8	≤60	2.4	447	1.7	190FG118K116150
1200	116	140	11.0	99	0.8	≤60	1.4	1115	2.1	190FG128K116140
1200	116	180	11.0	99	0.9	≤60	3.6	1115	2.4	190FG128K116180
1500	116	180	11.5	100	1.1	≤60	3.4	1116	2.4	190FG158K116180
1800	116	230	12.0	100	0.8	≤60	2.7	1118	2.8	190FG188K116230
2000	116	230	13.1	107	1.0	≤60	1.7	1201	3.0	190FG208K116230
2800	136	230	15.2	111	1.1	≤60	1.5	1213	4.1	190FG288K136230
3200	136	295	16.1	120	1.2	≤60	1.7	1300	4.5	190FG328K136295
			Un 1100v DC		Us 1650vDC	Ur 250vAC				
180	76	120	1.3	26	5.5	≤60	3.8	149	0.7	211FG187K76120
250	76	120	1.7	32	4.1	≤60	3.6	199	0.7	211FG257K76120
300	86	120	3.2	61	1.8	≤50	2.5	285	0.9	211FG307K86120
330	86	120	6.5	75	0.8	≤50	2.6	428	0.9	211FG337K86120
360	86	130	3.5	44	2.2	≤60	2.8	385	1.1	211FG367K86130

\*可以根据要求定做规格尺寸 Special design available to meet your requirements.

### ▲Technical Data

Cap (UF)	D mm	H mm	Ipeak (KA)	Irms@10Khz @45°C(A)	ESR@1.0K hz(MΩ)	Ls (nH)	Rth (k/W)	Wn (Ws)	Weight (kg)	Part number
			Un 1100v DC		Us 1650vDC	Ur 250vAC				
420	86	135	5.0	49	1.6	≤60	2.7	537	1.1	211FG427K86135
420	86	155	6.3	76	0.9	≤50	2.1	546	1.2	211FG427K86155
450	86	155	9.5	83	0.9	≤60	1.6	1022	1.5	211FG457K86155
500	86	174	6.7	76	1.2	≤60	1.8	723	1.3	211FG507K86174
620	116	125	13.4	113	0.5	≤55	1.3	1147	1.8	211FG627K116125
750	116	150	8.9	83	0.7	≤55	1.9	767	2.2	211FG757K116150
750	116	180	14.3	118	0.6	≤60	1.1	1531	2.3	211FG757K116180
780	116	150	14.4	118	0.9	≤60	3.6	1531	2.2	211FG787K116150
920	116	180	14.5	119	1.1	≤60	3.4	1532	2.3	211FG927K116180
1300	116	230	15.6	122	0.9	≤60	2.7	1541	3.0	211FG138K116230
1900	136	260	15.7	123	0.5	≤60	2.0	1549	4.7	211FG198K136260
2200	136	285	15.7	123	0.6	≤60	1.8	1549	4.5	211FG228K136285
2600	136	335	15.8	125	0.7	≤60	1.3	1550	6.0	211FG268K136335
2800	136	335	16.2	131	0.7	≤60	1.2	1610	6.0	211FG288K136335
			Un 1300vDC		Us 1950vDC	Ur 300vAC				
120	76	120	1.3	26	5.5	≤60	3.8	149	0.7	213FG127K76120
170	76	120	1.7	32	4.1	≤60	3.6	199	0.7	213FG177K76120
170	86	120	6.5	75	0.8	≤50	2.6	428	0.9	213FG177K86120
210	86	120	3.2	61	1.8	≤55	2.5	285	0.9	213FG217K86120
210	86	145	3.5	44	2.2	≤60	2.8	385	1.0	213FG217K86145
240	86	145	3.7	63	2.1	≤60	1.9	397	1.0	213FG247K86145
230	86	120	5.0	49	1.6	≤60	2.7	537	1.1	213FG237K86120
270	86	145	6.3	76	0.9	≤55	2.1	546	1.2	213FG277K86145
270	86	175	6.7	76	1.2	≤60	1.8	723	1.3	213FG277K86175
280	86	175	8.9	83	0.7	≤55	1.9	767	1.3	213FG287K86175
320	86	175	9.5	83	0.9	≤60	1.6	1022	1.3	213FG327K86175
320	116	125	14.3	118	0.6	≤60	1.1	1531	1.7	213FG327K116125
470	86	225	14.7	118	1.6	≤60	5.0	1535	1.7	213FG477K86225
520	116	150	13.4	113	0.5	≤55	1.3	1147	2.1	213FG527K116150
520	116	180	15.1	113	1.8	≤60	4.9	1540	2.4	213FG527K116180
540	116	150	15.3	115	1.0	≤50	3.6	1542	1.8	213FG547K116150
630	116	180	15.4	121	1.2	≤60	3.4	1551	3.0	213FG637K116180
820	116	230	16	122	0.9	≤50	2.7	1560	3.1	213FG827K116230
900	136	180	10	132	0.9	≤50	2.6	1601	3.3	213FG907K136180
1200	136	230	11	133	1.0	≤60	2.3	1601	4.1	213FG128K136230
1400	136	260	15	140	0.8	≤60	1.9	1720	4.6	213FG148K136260
1800	136	335	17	156	0.9	≤60	1.7	1720	6.0	213FG188K136335

\*可以根据要求定做规格尺寸 Special design available to meet your requirements.

### ▲Technical Data

Cap (UF)	D (mm)	H (mm)	Ipeak (KA)	Irms@10Khz @45°C(A)	ESR@1.0K hz(MΩ)	Ls (nH)	Rth (k/W)	Wn (Ws)	Weight (kg)	Part number
Un 1500vDC Us 1950vDC Ur 300vAC										
90	76	120	1.3	26	3.3	≤60	3.8	149	0.70	215FG906K76120
120	76	120	1.7	32	4.4	≤60	3.6	199	0.70	215FG127K76120
150	76	145	3.2	61	4.9	≤50	2.5	285	0.75	215FG157K76145
150	76	175	3.5	44	2.4	≤60	2.8	385	1.00	215FG157K76175
170	76	175	3.7	63	2.5	≤60	1.9	397	1.00	215FG177K76175
120	86	120	6.5	75	2.6	≤50	2.6	428	0.92	215FG127K86120
170	86	120	5.0	49	3.3	≤60	2.7	537	1.00	215FG177K86120
200	86	145	6.3	76	3.0	≤55	2.1	546	1.10	215FG207K86145
210	86	145	6.7	76	2.0	≤60	1.8	723	1.25	215FG217K86145
240	86	174	8.9	83	2.1	≤50	1.9	767	1.30	215FG247K86174
380	86	225	9.5	83	1.5	≤60	1.6	1022	1.80	215FG387K86225
230	116	125	13.4	113	1.4	≤55	1.3	1147	1.75	215FG237K116125
320	116	125	14.3	118	1.9	≤60	1.1	1531	1.75	215FG327K116125
390	116	150	14.7	118	2.1	≤60	5.0	1535	2.00	215FG397K116150
420	116	180	15.1	113	4.2	≤60	4.9	1540	2.40	215FG427K116180
470	116	180	15.3	115	1.3	≤50	3.6	1542	2.40	215FG477K116180
600	116	230	15.4	121	1.0	≤60	3.4	1551	2.80	215FG607K116230
Un 2000vDC Us 2850vDC Ur 400vAC										
75	76	120	1.2	22	8.9	≤60	4.0	138	0.7	220FG756K76120
100	86	120	1.4	24	6.5	≤60	3.5	180	0.9	220FG107K86120
150	86	175	2.9	48	3.0	≤55	2.6	290	1.3	220FG157K86175
190	116	125	2.8	39	3.4	≤60	2.9	365	1.7	220FG197K116125
200	86	225	2.9	55	3.5	≤60	1.9	343	1.7	220FG207K86225
220	116	150	5.6	67	1.2	≤50	2.0	404	2.1	220FG227K116150
270	136	125	4.1	42	2.4	≤60	2.1	520	2.3	220FG277K136125
280	116	180	5.5	65	1.5	≤50	2.1	523	2.4	220FG287K116180
380	116	230	5.6	67	1.8	≤60	1.7	689	3.0	220FG387K116230
400	136	180	7.6	72	1.2	≤55	2.0	743	3.3	220FG407K136180
540	136	230	7.6	73	1.3	≤60	1.6	978	4.1	220FG547K136230
600	136	260	11.6	104	0.8	≤50	1.5	1086	4.6	220FG607K136260
800	136	335	11.9	109	1.0	≤60	1.5	1508	6.0	220FG807K136335
Un 2500vDC Us 3750vDC Ur 600vAC										
95	116	130	2.0	46	2.6	≤50	2.8	321	1.8	225FG956K116130
130	136	130	2.5	50	1.9	≤50	2.4	445	2.5	225FG137K136130
200	116	230	1.8	50	4.5	≤60	1.7	645	3.0	225FG207K116230
280	136	230	2.4	56	3.6	≤60	1.5	875	4.1	225FG287K136230
350	136	335	3.3	66	3.1	≤60	1.2	1050	6.0	225FG357K136335

\*可以根据要求定做规格尺寸 Special design available to meet your requirements.

### ▲Technical Data

Cap (UF)	D (mm)	H (mm)	I <sub>peak</sub> (KA)	I <sub>rms</sub> @10Khz @45°C(A)	ESR@1.0K hz(MΩ)	L <sub>s</sub> (nH)	R <sub>th</sub> (k/W)	W <sub>n</sub> (Ws)	Weight (kg)	Part number
Un 3000vDC Us 4500vDC Ur 700Vac										
35	76	145	350	33	3.8	≤45	3.7	158	0.87	230FG356K76145
39	76	175	312	31	4.6	≤50	3.3	176	1.04	230FG396K76175
47	86	145	470	37	3.4	≤45	3.2	212	1.09	230FG476K86145
60	96	150	600	42	3.1	≤45	2.7	270	1.39	230FG606K96150
60	86	175	480	38	3.7	≤50	2.9	270	1.28	230FG606K86175
60	76	225	360	32	5.0	≤60	2.9	270	1.28	230FG606K76225
75	96	180	600	42	3.4	≤50	2.5	338	1.63	230FG756K96180
82	86	225	492	38	4.2	≤60	2.5	369	1.59	230FG826K86225
92	116	150	920	51	2.7	≤45	2.1	414	2.01	230FG926K116150
100	96	230	600	43	3.8	≤60	2.2	450	2.04	230FG107K96230
100	116	180	800	50	3.0	≤50	2.0	450	2.39	230FG107K116180
120	116	180	960	52	2.8	≤50	2.0	540	2.33	230FG127K116180
130	136	150	1300	59	2.5	≤45	1.7	585	2.72	230FG137K136150
150	116	230	900	52	3.2	≤60	1.7	675	2.93	230FG157K116230
160	136	180	1280	59	2.6	≤50	1.6	720	3.21	230FG167K136180
180	136	230	1080	59	3.0	≤60	1.4	810	4.11	230FG187K136230
Un 3600vDC Us 5400vDC Ur 800Vac										
42	116	130	1.3	40	3.8	≤45	2.9	276	1.8	236FG426K116130
60	136	130	1.8	45	2.8	≤45	2.7	389	2.5	236FG606K136130
88	116	230	1.2	42	6.7	≤65	1.8	589	3.0	236FG886K116230
130	136	230	1.8	45	5.0	≤65	1.5	870	4.1	236FG136K136230
Un 4000vDC Us 6000vDC Ur 900vAC										
33	116	130	1.3	36	4.2	≤40	2.8	276	1.9	240FG336K116130
47	136	130	1.7	39	3.9	≤40	2.9	376	2.5	240FG476K136130
70	116	230	1.3	32	7.6	≤60	1.8	570	3.0	240FG706K116230
100	136	230	1.9	38	5.8	≤60	2.0	822	4.1	240FG107K136230

\*可以根据要求定做规格尺寸 Special design available to meet your requirements.